

TLES4F

Energy-optimized Compressor

R134a

220-240V 50Hz

Data Sheet (Replaces CG.42.D2.02)

General

Compressor	TLES4F
Code number	102G4410

Application

Application	LBP
Evaporating temperature range	°C -35 to -10
Voltage range	V/Hz 198 - 254 /50
Motor type	RSIR/RSCR
Max. ambient temperature	°C 43
Comp. cooling at ambient temp.	32°C S
	38°C S
	43°C S

Design

Displacement	cm ³	3.86
Oil quantity	cm ³	180
Maximum refrigerant charge	g	400
Free gas vol. in compressor	cm ³	1790
Weight without electrical equipment	kg	7.5

Motor

Motor size	watt	80
LRA (rated after 4 sec. UL984) LST	A	2.9
Cut-in current LST	A	7.6
Resistance, main and start winding (25°C)	Ω	25.7/15.7
Approvals	EN 60335-2-34 with Annex AA	

Dimensions

Height	mm	A	173
		B	169
Suction connector	location/I.D. mm	C	6.2 ±0.09
Process connector	location/I.D. mm	D	6.2 ±0.09
Discharge connector	location/I.D. mm	E	5.0 +0.12/+0.20
Compressors on a pallet	pcs.		125

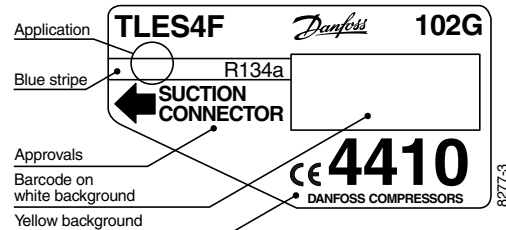

- S = Static cooling normally sufficient
- O = Oil cooling
- F₁ = Fan cooling 1.5 m/s
(compressor compartment temperature equal to ambient temperature)
- F₂ = Fan cooling 3.0 m/s necessary

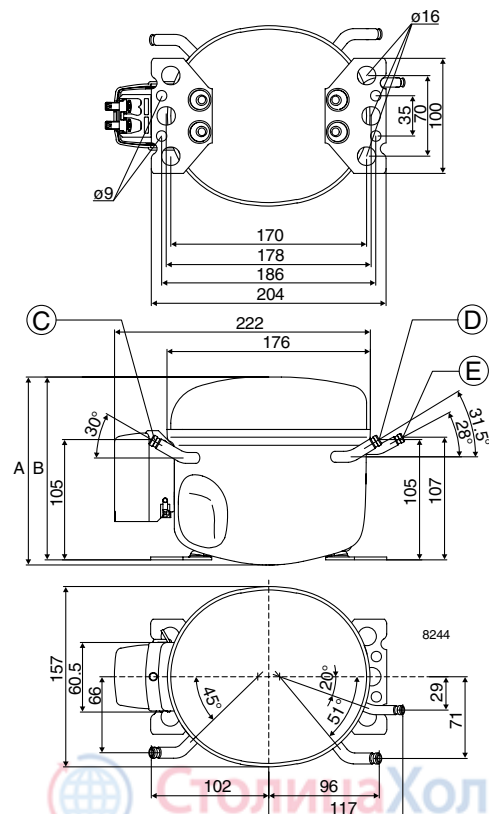

Capacity (EN 12900/CECOMAF)
watt

Comp.\°C	-35	-30	-25	-23.3	-20	-15	-10
TLES4F	32.6	49.5	70.0	77.9	94.8	124	160

Capacity (ASHRAE)
watt

Comp.\°C	-35	-30	-25	-23.3	-20	-15	-10
TLES4F	40.1	61.1	86.4	96.2	117	154	197

Power consumption
watt

Comp.\°C	-35	-30	-25	-23.3	-20	-15	-10
TLES4F	59.9	69.5	80.0	83.8	91.4	104	118

Current consumption
A

Comp.\°C	-35	-30	-25	-23.3	-20	-15	-10
TLES4F	0.45	0.49	0.54	0.56	0.60	0.66	0.73

COP (EN 12900/CECOMAF)
W/W

Comp.\°C	-35	-30	-25	-23.3	-20	-15	-10
TLES4F	0.54	0.71	0.88	0.93	1.04	1.20	1.35

COP (ASHRAE)
W/W

Comp.\°C	-35	-30	-25	-23.3	-20	-15	-10
TLES4F	0.67	0.88	1.08	1.15	1.28	1.48	1.67

Test conditions

EN 12900/CECOMAF

ASHRAE

Condensing temperature

55°C

55°C

Ambient and suction gas temp.

32°C

32°C

Liquid temperature

55°C

32°C

Static cooling, 220V 50Hz,

PTC consumption incl.

Accessories

Devices		Fig.	TLES4F
PTC starting device	6.3 mm spades	a1 (pos.1)	103N0011
	4.8 mm spades		103N0018
PTC starting device	6.3 mm spades	a1 (pos.2)	103N0016
	4.8 mm spades		103N0021
Cover		b	103N2010
Cord relief		d	103N1010
Run capacitor 4 µF (optional)	6.3 mm spades	e	117-7117
	4.8 mm spades		117-7119
Protection screen for PTC		g	103N0476
Mounting accessories			
Bolt joint for one compressor			118-1917
Bolt joint in quantities			118-1918
Snap-on in quantities			118-1919

